



West Winch Housing Access Road

Stopping Up and Diversion of Highways and Public Rights of Way Drawings

Author: WSP

Document Reference: NCC/2.09.00

Version Number: P02

Date: December 2023



Contents

1	Introduction	4
1.1	Overview	4
1.2	Stopping Up and Diversion of Highways and Public Rights of Way Drawings	4
2	Drawings	4



1 Introduction

1.1 Overview

- 1.1.1 This set of drawings presents the layout of the proposed West Winch Housing Access Road (WWHAR) scheme in relation to the surrounding area.
- 1.1.2 This drawing set shows the proposals over Ordinance Survey mapping which outlines the proposals in relation to the villages of West Winch, North Runcton and the existing road network.
- 1.1.3 This set of drawings shows the highway proposals only and does not show the proposed housing development or any landscaping associated with the scheme.
- 1.1.4 The drawing set included in this pack is as follows;

1.2 Stopping Up and Diversion of Highways and Public Rights of Way Drawings

- 1.2.1 Figures 1 to 4 show the highway scheme proposals and areas of proposed and altered carriageway together with areas of existing carriageway to be stopped up.
- 1.2.2 These drawings also show existing private means of access to be stopped up, new private means of access, existing and proposed footways / cycle tracks, existing Public Rights of Way (PRoW), PRoW to remain, be stopped up & new lengths of PRoW.

2 Drawings

- 2.1.1 The following drawings described above are provided on the following pages.

Figure 1 – Housing Access Road Proposed Stopping Up and Diversion of Highways and Public Rights of Way Drawing Sheet 1 of 2

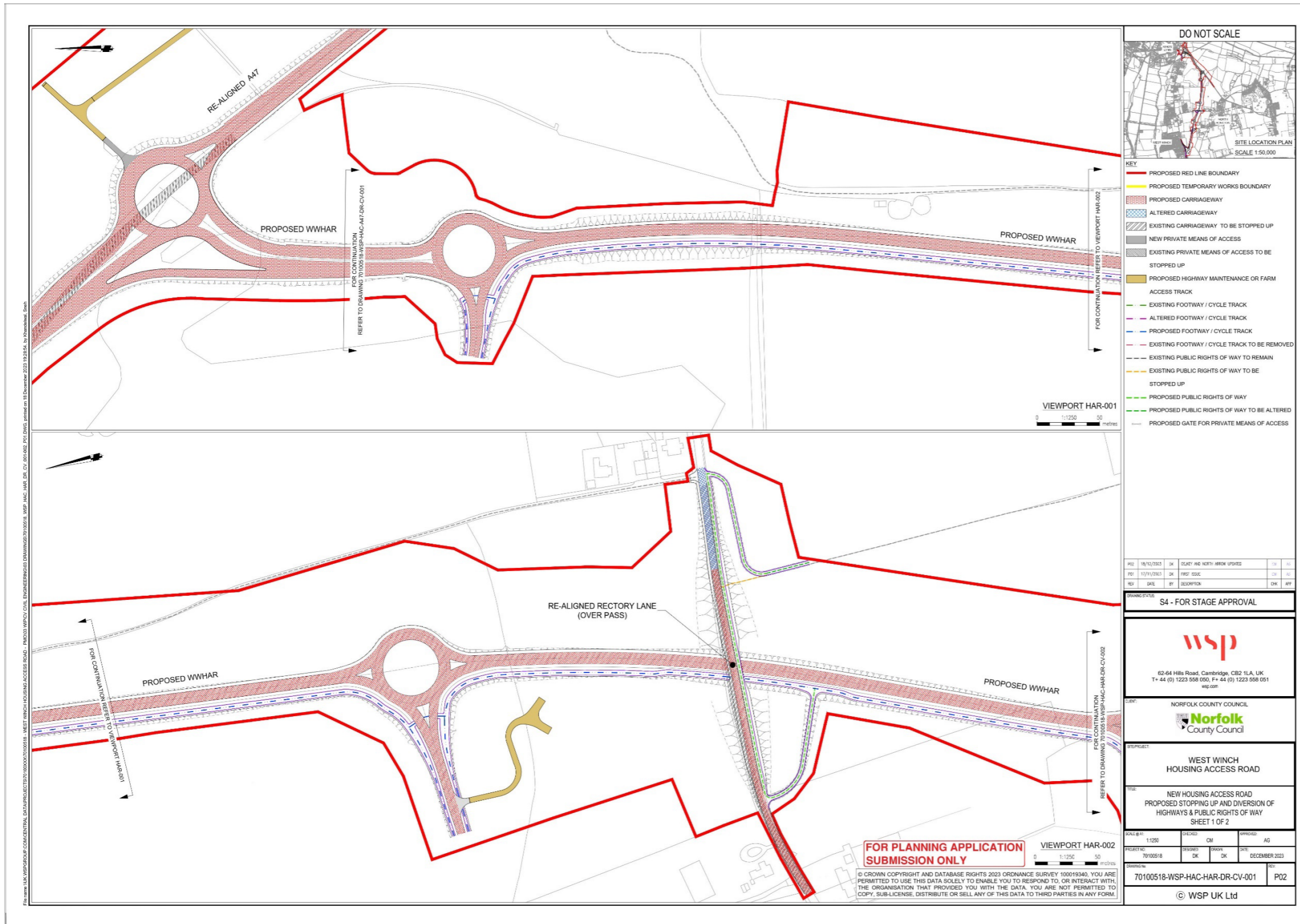

Figure 2 – Housing Access Road Proposed Stopping Up and Diversion of Highways and Public Rights of Way Drawing Sheet 2 of 2

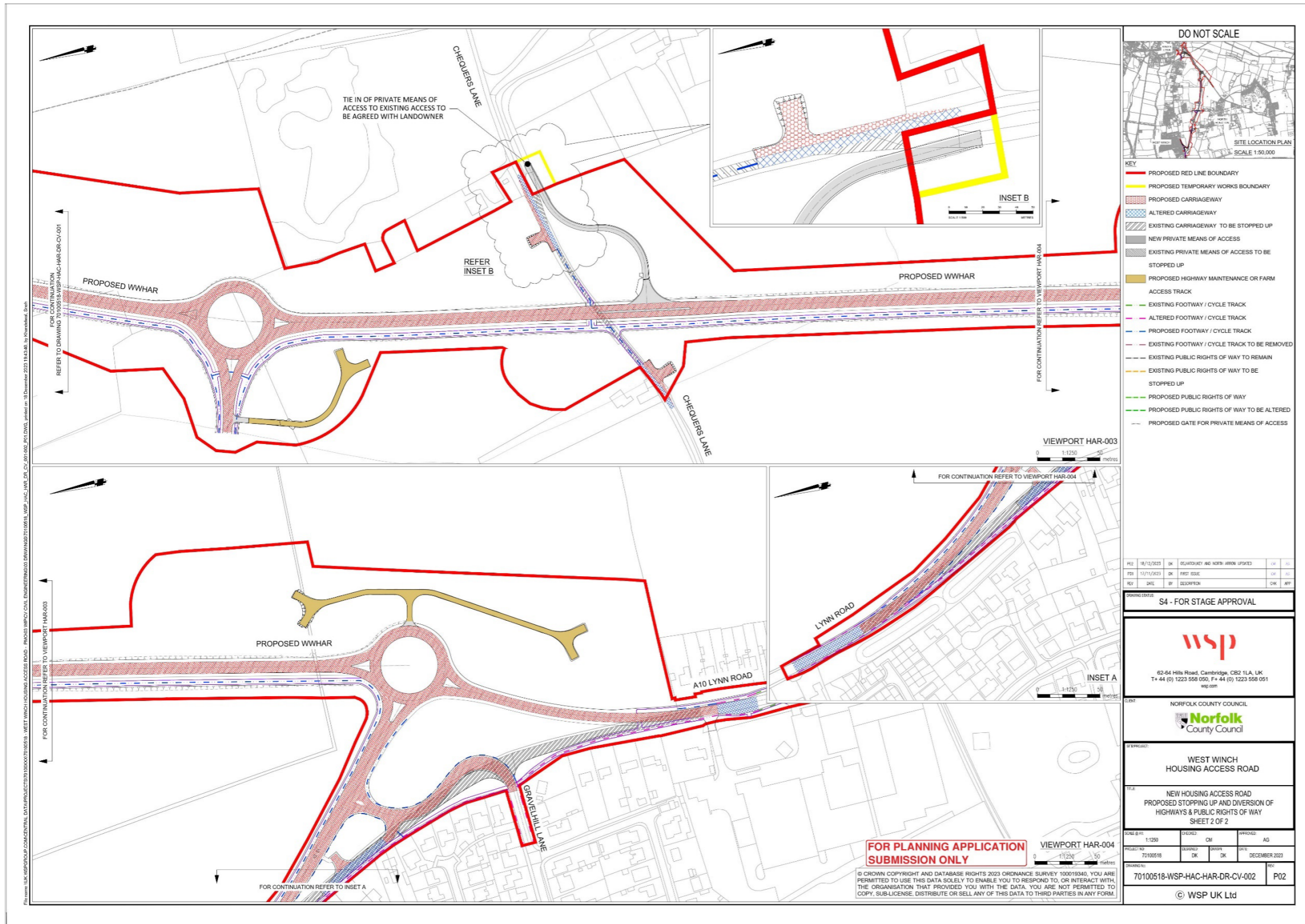

Figure 3 – A47 Proposed Stopping Up and Diversion of Highways and Public Rights of Way Drawing Sheet 1 of 2

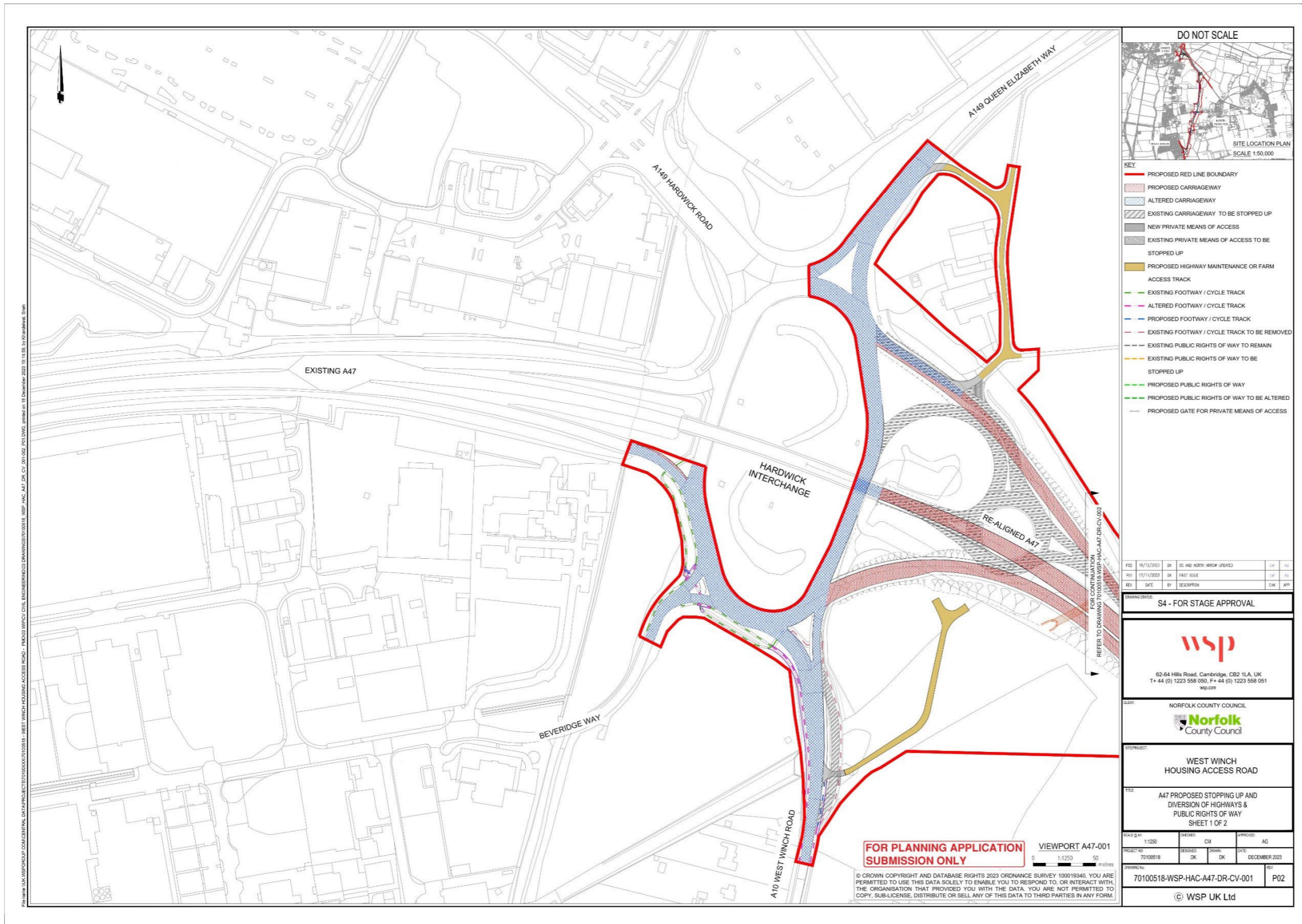

Figure 4 – A47 Proposed Stopping Up and Diversion of Highways and Public Rights of Way Drawing Sheet 2 of 2

