

APPROVED FOR MANUFACTURE:

DATE:

INITIALS:

D1, D2, D3

**HARDWARE**

4.5MM GAP STD HINGE 100X76 SSS DOG BOLT  
HOOPLY MULTIPPOINT SASHLOCK C/W LEVER SET  
SECUREFAST TS007 1 STAR 80MM (40/40) EURO DOUBLE CYLINDER NICKEL FINISH - SSC4040-NI  
HOPPE PAIR SECURITY ESCUTCHEONS - ID NO. 11723774  
MEDIUM DUTY FRICTION STAY

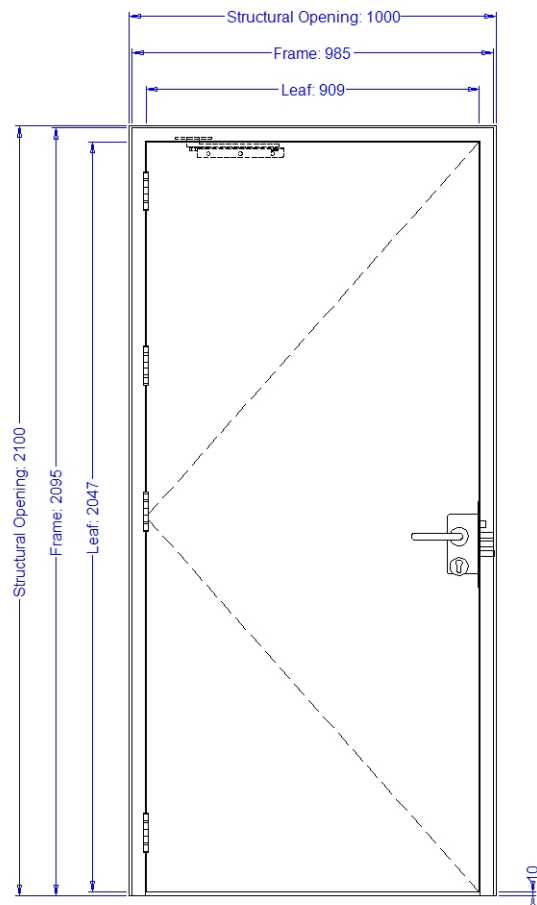

**HANDING  
TBC**

VIEWED FROM OUTSIDE

**VISION PANEL/LOUVRES**

**NOTES**

**FINISH**

<b>LEAF:</b> PPC FROM STD RANGE Matt 30% (eggshell/matt) GOOSEWING GREY BS 10 A 05	<b>FRAME:</b> PPC FROM STD RANGE* Matt 30% (eggshell/matt) GOOSEWING GREY BS 10 A 05
---	---

<b>SECURITY RATING (IF APPLICABLE)</b>	<b>APPROX WEIGHT</b> 55.8 kg
--	------------------------------

**TYPE:** OUTA-DOR  
**FIRE RATING:** NIL  
**INFILL:** MINERAL WOOL 1.6 w/m<sup>2</sup>K

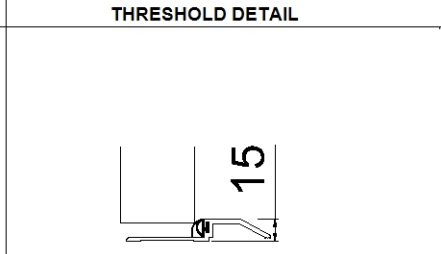
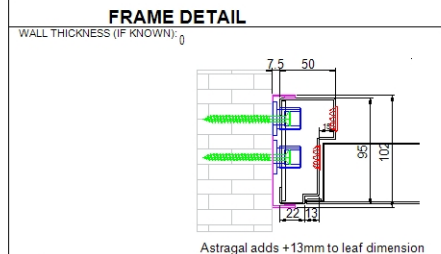

ESTABLISHED 1920

**TITLE:** Q63169/24 - REGEN HOLDINGS SYSTON ROLLING SHUTTERS LTD

**DRAWING NO:** Q63169/24-1

**INITIALS:** JM

**SCALE:** NTS

**REV:**

**DATE:** 06/02/2024