



# **West Winch Housing Access Road, Arboricultural Impact Assessment. Appendix D: Tree Removals and Protection Plan. Part 8 of 8**

Author: WSP

Document Reference: NCC/4.04.04

Version Number: 001

Date: November 2023



## Contents

1 Introduction ..... 3

### Figures

Figure 1-17 – Tree Removal and Protection Plan – Page 17 of 18 ..... 4  
Figure 1-18 – Tree Removal and Protection Plan – Page 18 of 18 ..... 5



## 1 Introduction

- 1.1.1 The below figures provide supporting visual information with regards to the main text of **Appendix 8.17** (Arboricultural Impact Assessment (AIA))
- 1.1.2 The figures all include the outline of the Proposed Scheme, the Proposed Scheme boundary and locations of surveyed arboricultural features. Locations of arboricultural features are sequentially presented in a general south to north direction with each figure.
- 1.1.3 The figures all include the extents of tree removal extents, protective fencing, mitigation areas plus retained tree canopies and Root Protection Areas of each surveyed arboricultural feature.
- 1.1.4 Figures 1-1 to 1-3 are included in part 1 of this document.
- 1.1.5 Figures 1-4 to 1-6 are included in part 2 of this document.
- 1.1.6 Figures 1-7 to 1-9 are included in part 3 of this document.
- 1.1.7 Figures 1-10 to 1-11 are included in part 4 of this document.
- 1.1.8 Figures 1-12 to 1-13 are included in part 5 of this document.
- 1.1.9 Figure 1-14 is included in part 6 of this document.
- 1.1.10 Figures 1-15 to 1-16 are included in part 7 of this document.
- 1.1.11 Figures 1-17 to 1-18 are included in part 8 of this document.

Figure 1-17 – Tree Removal and Protection Plan – Page 17 of 18

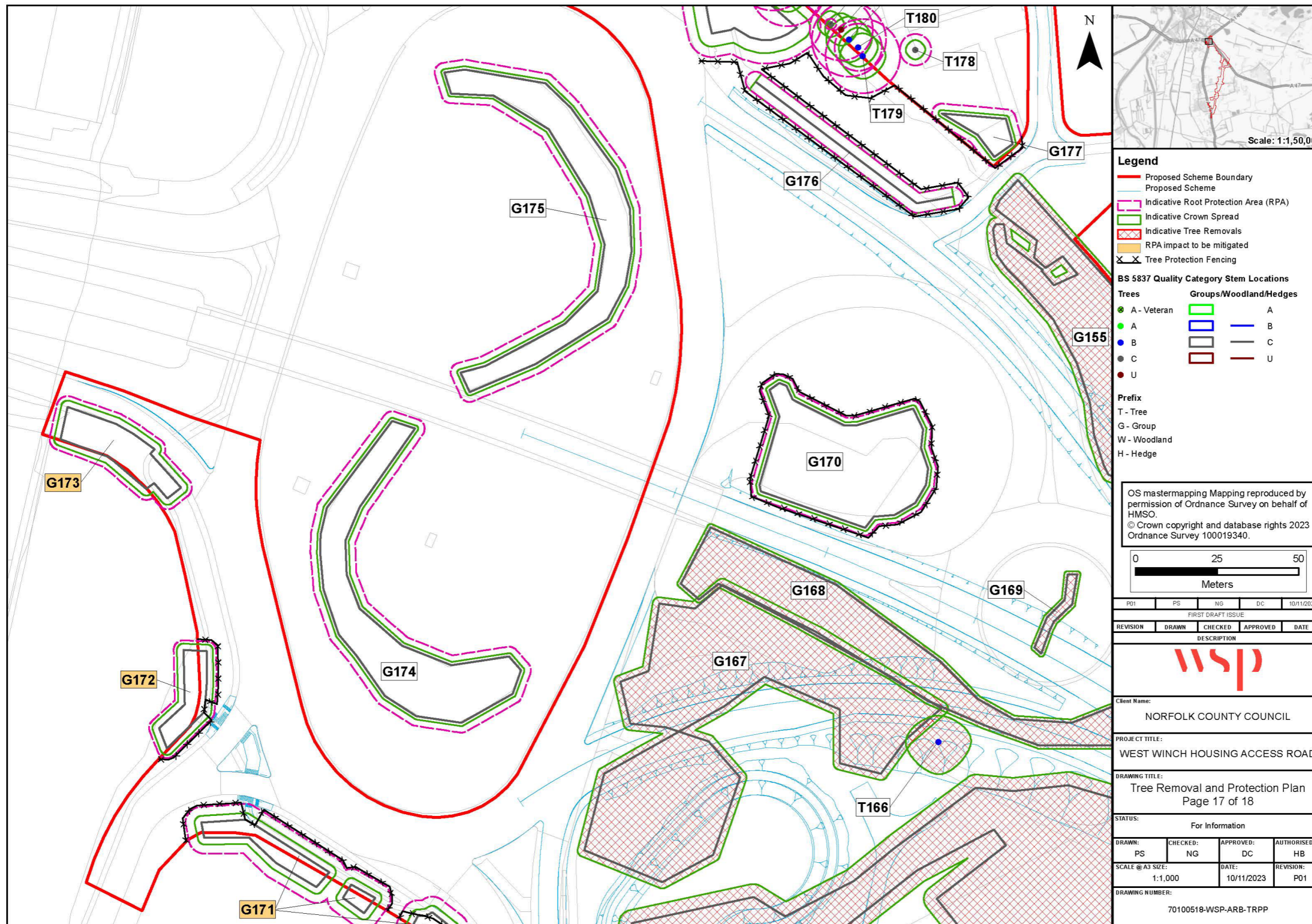

- Legend**
- Proposed Scheme Boundary
  - Proposed Scheme
  - Indicative Root Protection Area (RPA)
  - Indicative Crown Spread
  - Indicative Tree Removals
  - RPA impact to be mitigated
  - X Tree Protection Fencing

**BS 5837 Quality Category Stem Locations**

Trees	Groups/Woodland/Hedges
<span style="color: green;">●</span> A - Veteran	<span style="border: 1px solid green; display: inline-block; width: 10px; height: 10px;"></span> A
<span style="color: blue;">●</span> A	<span style="border: 1px solid blue; display: inline-block; width: 10px; height: 10px;"></span> B
<span style="color: red;">●</span> B	<span style="border: 1px solid red; display: inline-block; width: 10px; height: 10px;"></span> C
<span style="color: black;">●</span> C	<span style="border: 1px solid black; display: inline-block; width: 10px; height: 10px;"></span> U
<span style="color: red;">●</span> U	

**Prefix**  
 T - Tree  
 G - Group  
 W - Woodland  
 H - Hedge

OS mastermapping Mapping reproduced by permission of Ordnance Survey on behalf of HMSO.  
 © Crown copyright and database rights 2023  
 Ordnance Survey 100019340.

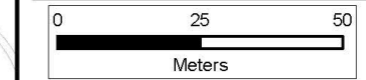

P01	PS	NG	DC	10/11/2023
FIRST DRAFT ISSUE				
REVISION	DRAWN	CHECKED	APPROVED	DATE
DESCRIPTION				



Client Name:  
 NORFOLK COUNTY COUNCIL

PROJECT TITLE:  
 WEST WINCH HOUSING ACCESS ROAD

DRAWING TITLE:  
 Tree Removal and Protection Plan  
 Page 17 of 18

STATUS:  
 For Information

DRAWN:	CHECKED:	APPROVED:	AUTHORISED:
PS	NG	DC	HB
SCALE @ A3 SIZE:	DATE:	REVISION:	
1:1,000	10/11/2023	P01	

DRAWING NUMBER:  
 70100518-WSP-ARB-TRPP

Figure 1-18 – Tree Removal and Protection Plan – Page 18 of 18

